

# GO device installation using HRN-ES12S1 in European heavy-duty vehicles

This document describes how to install a GO device in European heavy-duty vehicles using the HRN-ES12S1 harness. The primary consideration is finding the vehicle's Fleet Management System (FMS) interface.

## Step 1

Find the FMS interface in the vehicle. The exact location depends on vehicle make and model, but it is usually located around the fuse board, near the radio, or in the headliner.

Around the fuse board:

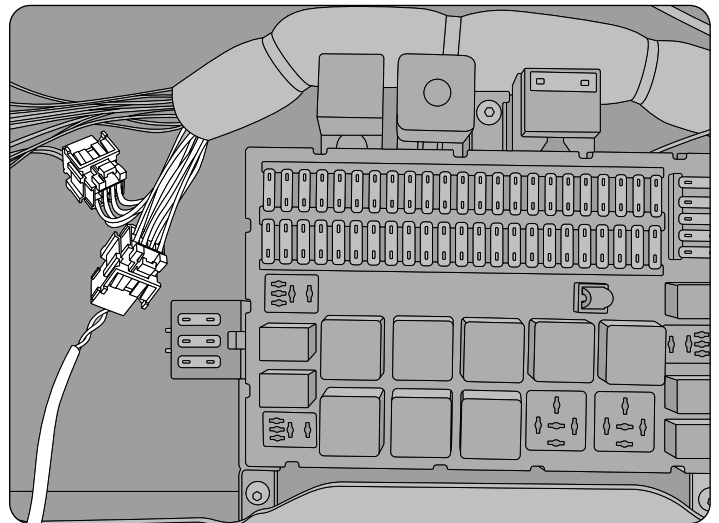
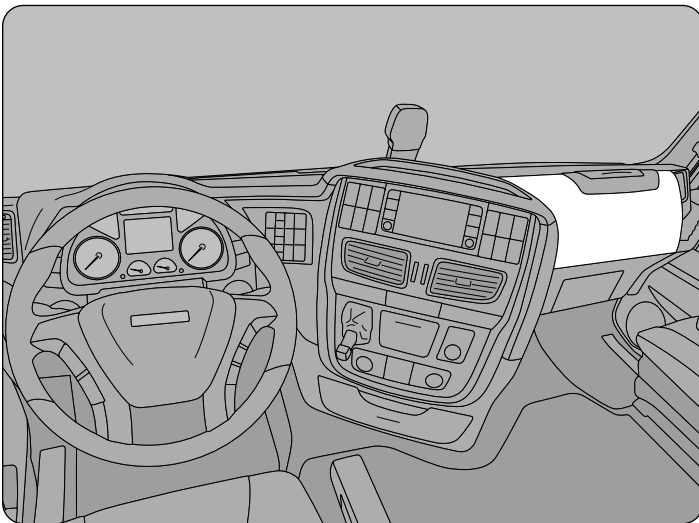

Behind/Around the radio:

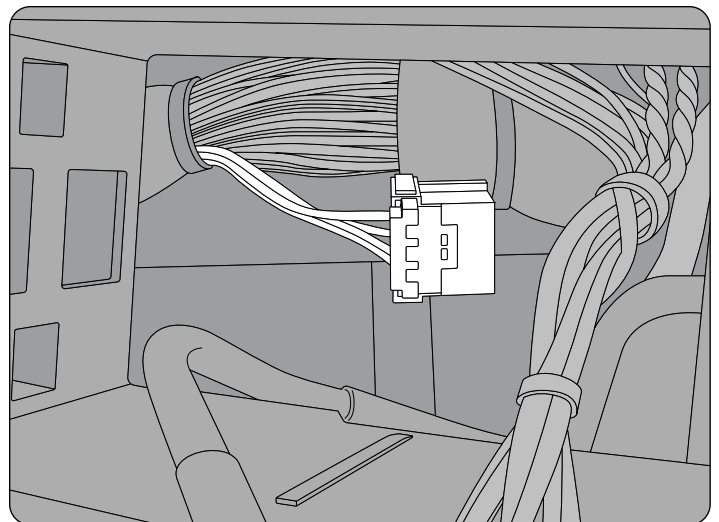
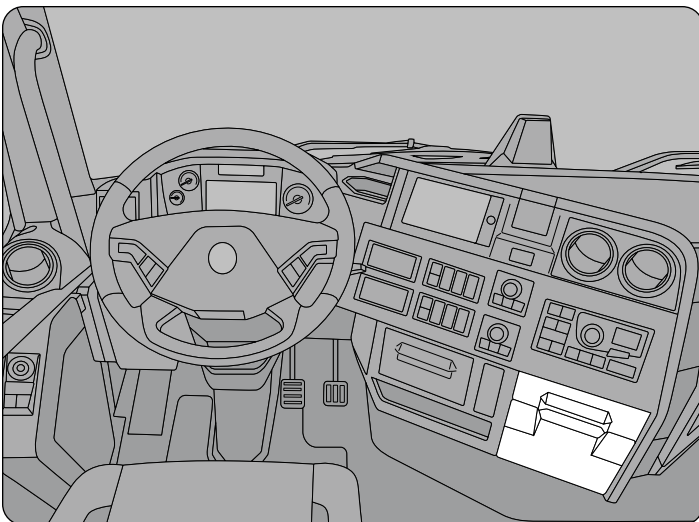

Headliner:

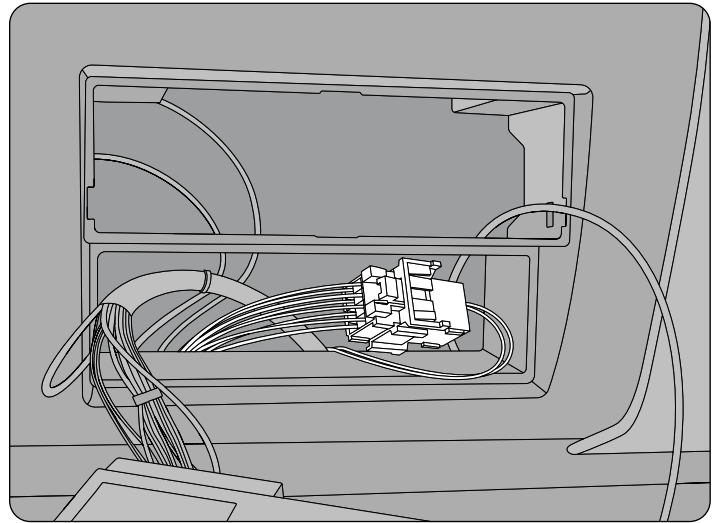
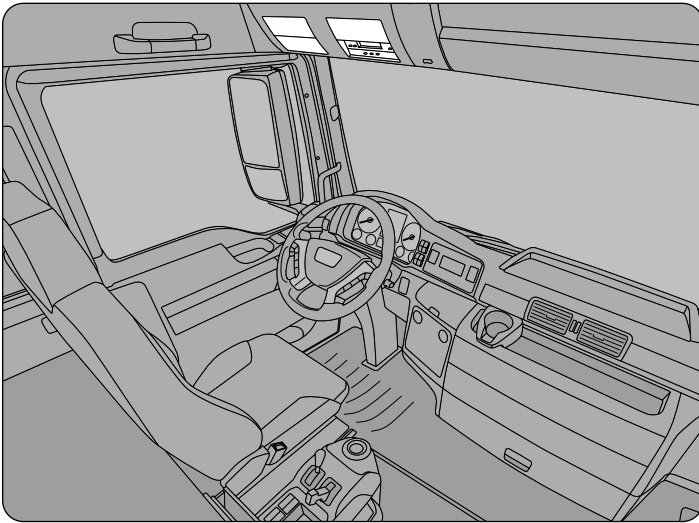

## Step 2

Connect the HRN-ES12S1 harness to the FMS interface.

## Step 3

Connect the HRN-ES12S1 harness to the GO device.

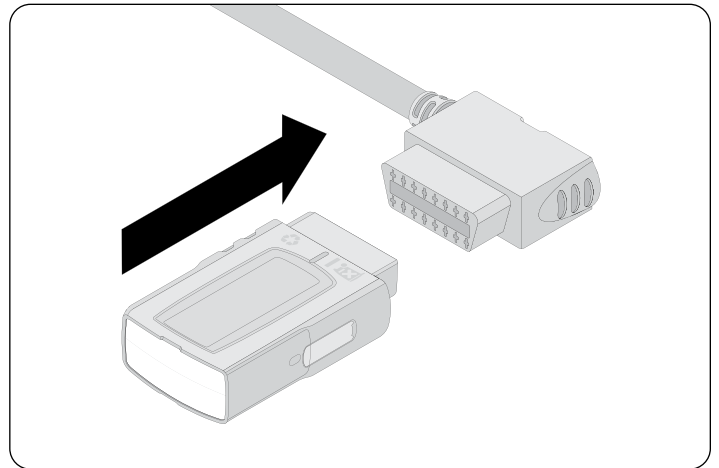

## Step 4

Once the GO9 installation is complete, start the vehicle and wait for the GO device to initialize.

This process can take up to five minutes and the device will beep throughout. Ensure that all three LEDs are active:

- The **red** LED indicates ignition
- The **blue** LED indicates GPS signal
- The **green** LED indicates a cellular network connection

If any of the LEDs are not active, please contact support for troubleshooting.

When done, reinstall all dash panels and clean up the installation area.

